

4150 Series Damaged Block Window Full Insert Replacement

Repairing a Crystal View™ acrylic block window with a full insert replacement is a simple procedure meant for the replacement of a block window that is damaged beyond repair. Please refer to the individual block replacement instructions or scratch repair instructions when only individual blocks need replacement or scratch repair. Contact Customer Service at 1.888.921.7086 for further instructions and assistance, if necessary.

Be sure to read the step-by-step instructions carefully before beginning the repair. The steps laid out in these instructions are basic in process and follow the repair in a chronological order. Remember to wear safety glasses and safety gloves throughout the repair and take any necessary precautions to assure your safety. When done properly, a Crystal View™ acrylic block window's full insert replacement will take approximately 45 - 60 minutes.



Step #1

Using a utility knife, cut a slit in the middle of the grout line around the perimeter blocks of the damaged unit being replaced. Use smooth, easy strokes to be sure to not damage the frame surrounding the damaged blocks. Follow this procedure on both sides of the window.

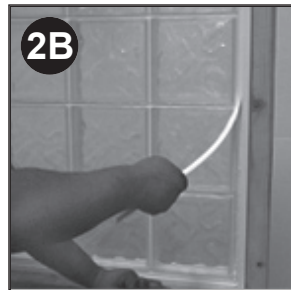
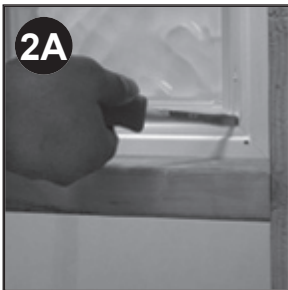

Step #2

Remove the hidden glazing bead holding the blocks into the frame.

(Step 2A) Locate the hidden glazing bead by identifying the mitered corners on the perimeter of the vinyl frame next to the grout line. The glazing bead will be located on the outside of the structure if it was installed with a 1 3/8" nail fin setback or on the inside of the structure if it was installed with a 7/8" nail fin setback. Using a narrow flat head screwdriver, pry into one of the 45° miters of the glazing bead and with a rubber mallet or the palm of your hand, drive the screwdriver into the gap between the mitered glazing bead.

(Step 2B) Peel each glazing bead out of its channel and remove the assembled block unit from the vinyl frame installed into the opening.

Step #3

Clear away the remaining grout.

Using a putty knife, clear the remaining silicone from the perimeter grout channel of the vinyl frame. Approximately 75% of the grout can be removed this way. Not all of the remaining grout will need to be removed for the repair. Be careful not to damage the surrounding frame as the silicone is cut loose.

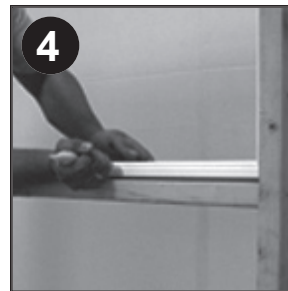

Step #4

Roll the bottom replacement glazing bead into place.

Using a window or screen rolling tool, roll one of the pre-cut replacement glazing beads into the corresponding channel at the bottom of the frame, with the silicone groove facing the interior of the opening.



Step #5

Insert the Block Replacement Unit into the opening.

Using the sticker at the bottom of the insert replacement unit as a guide, insert the unit, bottom first, into the opening. Make sure to line up the bottom row of connecting tabs, placing them in between the fixed frame and the bottom glazing bead already in place.



4150 Series Damaged Block Window Full Insert Replacement, Cont'd.



Step #6

Roll the remaining Replacement Glazing Bead into place. Using a window or screen rolling tool, roll the remaining pre-cut replacement glazing beads into their corresponding channels at the top and on both sides of the frame, with the silicone groove facing the interior of the opening.



Step #7

Clean and prepare the perimeter grout line for silicone. Using a Q-tip or a paper towel and isopropyl alcohol, clean the perimeter grout line to ensure good silicone adhesion between the acrylic block and vinyl frame. Follow this procedure on both sides of the window. It is best to work on one side at a time.



Step #8

Grout the perimeter grout line. Using a caulking gun and the siliconized grout provided, grout the perimeter grout line around the replacement insert unit. Be careful not to get too much excess grout on the surrounding blocks and the frame. Follow this procedure on both sides of the window. It is best to work on one side at a time.



Step #9

Remove excess grout from grout line. Using the grout tool provided, clear away the excess siliconized grout from the grout line. Use smooth strokes, being careful not to dig too deep into the grout line. Follow this procedure on both sides of the window. It is best to work on one side at a time.

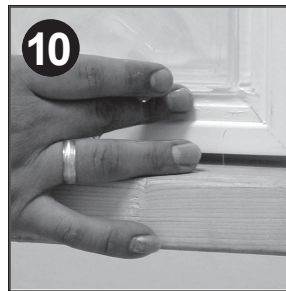

Step #10

Smooth out grout in grout line. Dip your index finger into a solution of mild dish soap and water. Run your finger across each grout line of the replacement block(s) to smooth out the siliconized grout in the grout line. Follow this procedure on both sides of the window.



Step #11

Clean up any remaining excess silicone grout. Using the grout tool provided or a paper towel, carefully clean up any remaining excess siliconized grout from around the perimeter acrylic blocks and vinyl frame. If a more thorough cleanup is necessary, wait for the siliconized grout to completely cure overnight and return to rub away the dry silicone, using a soft cotton cloth.